

# DELUGE VALVE MODEL GY

(Groove\*Groove/Flange\*Flange/Flange\*Groove)



## TECHNICAL DATA

CERTIFICATE	<b>UL Listed</b> <b>FM Approved</b>
CONNECTION	Flange ANSI B16.1 Class 150/300, DIN2501 PN16/25, grooved AWWA C606/ISO 6182
FUNCTION	Electrical actuation (Standard), Pneumatic actuation.
W. PRESSURE	250 / 300 psi (17.5 / 20.7 bar)
AVAILABLE SIZE	2" – 8"
SURFACE FINISH	Red to RAL 3001
FACTORY HYDROSTATIC TEST PRESSURE	35 kg/sq.cm 500 psi
MINIMUM OPERATING PRESSURE	1.4 kg/sq.cm
TEMPERATURE RATING	4°C to 70°C
NET WEIGHT	Refer Table
MOUNTING	Vertical or Horizontal
SIN NUMBER	GY46X/GY46X-300 GY56X/GY56X-300 GY86X/GY86-300



## DESCRIPTION

JYCO Deluge Valve is known as a system control valve in a deluge system, used for fast application of water in a spray system. Deluge valve protects areas such as power transformer installation, storage tank, conveyor protection and other industrial application etc. With the addition of foaming agent, deluge valve can be used to protect aircraft hanger and inflammable liquid fire.

## MAIN PARTS AND MATERIAL

<b>Body / cover</b>	Ductile iron as ASTM A536, 65-45-12	<b>Diaphragm</b>	BNR rubber as ASTM D2000
<b>Standard Accessories</b>	Complete pipelines for electrical actuation, solenoid valve, etc.	<b>Pre-assembly components</b>	Water motor gong, alarm pressure switch, pressure gauge

## AVAILABLE SIZE

Size		L	Actuation type	Connection	Working pressure (psi)	Ref.No.
Inch	DN	mm				
2"	DN50	287	Electrical / wet / dry	FxF, GxG, FxG	250/300	GY46X/GY46X-300 GY56X/GY56X-300 GY86X/GY86-300
2-1/2"	DN65	287	Electrical / wet / dry	FxF, GxG, FxG	250/300	GY46X/GY46X-300 GY56X/GY56X-300 GY86X/GY86-300
3"	DN80	340	Electrical / wet / dry	FxF, GxG, FxG	250/300	GY46X/GY46X-300 GY56X/GY56X-300 GY86X/GY86-300

4"	DN100	390	Electrical / wet / dry	FxF, GxG, FxG	250/300	GY46X/GY46X-300 GY56X/GY56X-300 GY86X/GY86-300
6"	DN150	508	Electrical / wet / dry	FxF, GxG, FxG	250/300	GY46X/GY46X-300 GY56X/GY56X-300 GY86X/GY86-300
8"	DN200	584	Electrical / wet / dry	FxF, GxG, FxG	250/300	GY46X/GY46X-300 GY56X/GY56X-300 GY86X/GY86-300

**Note:**

1. For wet pilot line trim, it includes different trim pipeline.
2. For dry pilot line trim, it includes different trim pipeline, air compressor, pneumatic actuator.
3. The flanged end connection is available with ANSI B16.1 Class 150/300, DIN2501 PN16/25, grooved AWWA C606/ISO 6182.

**STRUCTURAL CHARACTERISTICS**

**Structural characteristics**

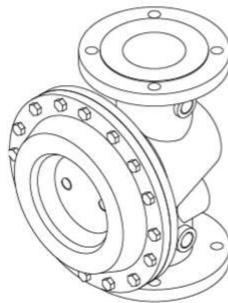

**Type Description**

GY46X	FXF 250PSI
GY46X-300	FXF 300PSI

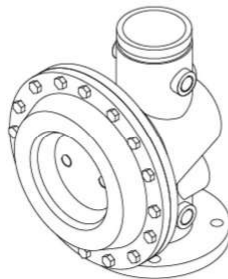

**Type Description**

GY56X	FXG 250PSI
GY56X-300	FXG 300PSI

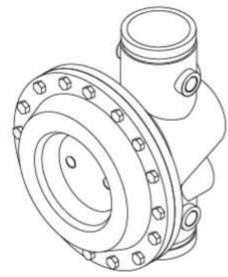

**Type Description**

GY86X	GXG 250PSI
GY86X-300	GXG 300PSI

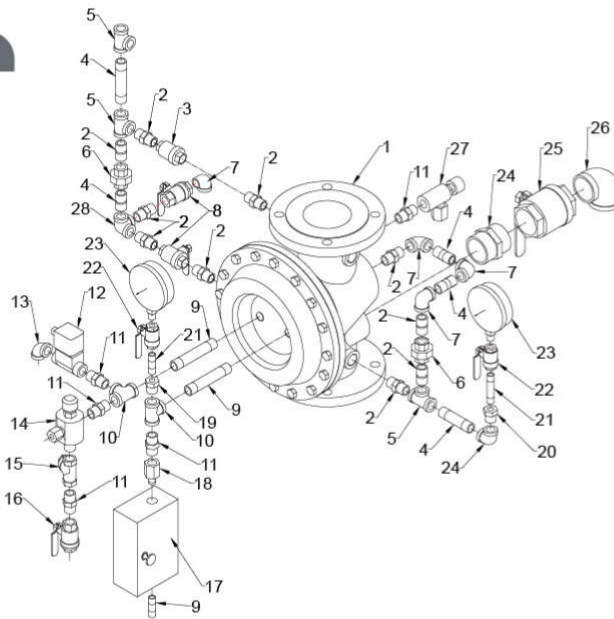

NO.	Name	Qty	Size	Material	Standard
1	Deluge valve	1			
2	Butt joint	n	3/4"	DI/CF8/CF8M/C95400/C95800	ASTM A536/A351/B148
3	Check valve	1	3/4"	CF8/CF8M/C95400/C95800	ASTM A351/B148
4	Pipe fittings	n	3/4"	Gr.A/TP304/C60800	ASTM A53/A312/B111M
5	Tee joint	n	3/4"	DI/CF8/CF8M/C95400/C95800	ASTM A536/A351/B148
6	Union	2	3/4"	DI/CF8/CF8M/C95400/C95800	ASTM A536/A351/B148
7	90° Joint	n	3/4"	DI/CF8/CF8M/C95400/C95800	ASTM A536/A351/B148
8	Ball valve	2	3/4"	CF8/CF8M/C95400/C95800	ASTM A351/B148
9	Pipe fittings	n	1/2"	Gr.A/TP304/C60800	ASTM A53/A312/B111M
10	Tee joint	2	1/2"	DI/CF8/CF8M/C95400/C95800	ASTM A536/A351/B148
11	Butt joint	n	1/2"	DI/CF8/CF8M/C95400/C95800	ASTM A536/A351/B148
12	Solenoid valve	1	1/2"		
13	90° Joint	n	1/2"	DI/CF8/CF8M/C95400/C95800	ASTM A536/A351/B148
14	Manual reset valve	1	1/2"		
15	Y type filter	1	1/2"	CF8/CF8M/C95400/C95800	ASTM A351/B148
16	Ball valve	2	1/2"	CF8/CF8M/C95400/C95800	ASTM A351/B148
17	Emergency release valve bank	1			
18	Release valve joint	1	1/2"	DI/CF8/CF8M/C95400/C95800	ASTM A536/A351/B148
19	Joint	1	1/2"-1/4"	DI/CF8/CF8M/C95400/C95800	ASTM A536/A351/B148
20	Joint	1	3/4"-1/4"	DI/CF8/CF8M/C95400/C95800	ASTM A536/A351/B148
21	Pipe fittings	n	1/4"	Gr.A/TP304/C60800	ASTM A53/A312/B111M
22	Ball valve	2	1/4"	CF8/CF8M/C95400/C95800	ASTM A351/B148
23	Pressure gauge	2			
24	Butt joint	1	3/4"-2"	DI/CF8/CF8M/C95400/C95800	ASTM A536/A351/B148
25	Ball valve	1	3/4"-2"	CF8/CF8M/C95400/C95800	ASTM A351/B148
26	90° Joint	1	3/4"-2"	DI/CF8/CF8M/C95400/C95800	ASTM A536/A351/B148
27	Drip valve	1	1/2"		
28	Stereoscopic tee joint	1	3/4"	DI/CF8/CF8M/C95400/C95800	ASTM A536/A351/B148

## DIMENSION in millimeter (Approximate)

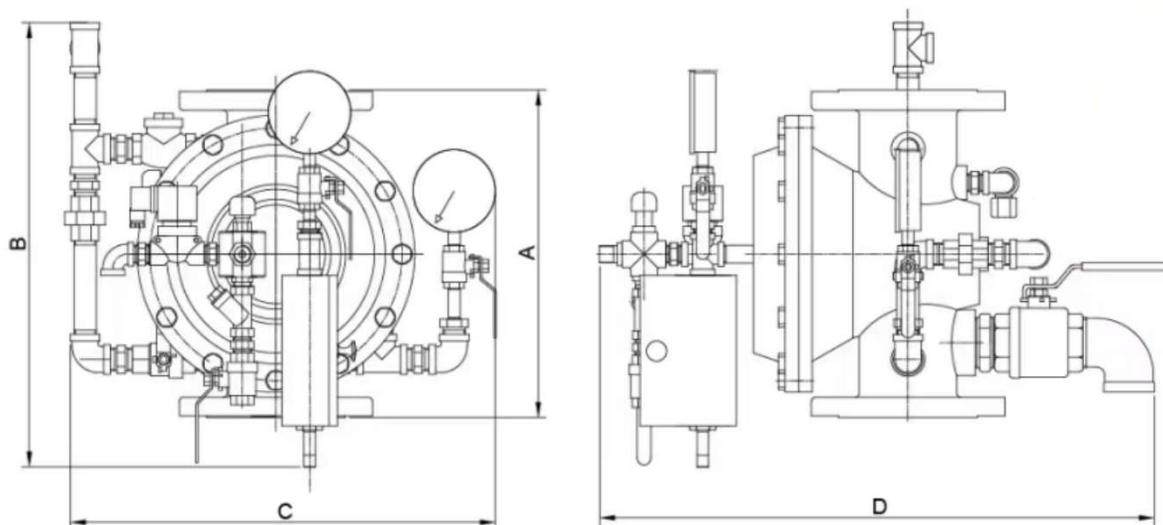

Specification	Diameter(in/mm)	A(mm)	B(mm)	C(mm)	D(mm)
GY46X02	2/50	287±2	440±10	460±10	500±10
GY46X25	2.5/65	287±2	440±10	460±10	540±10
GY46X03	3/80	340(324)±2	450±10	490±10	570±10
GY46X04	4/100	390(350)±2	520±10	490±10	680±10
GY46X06	6/150	508(460)±2	570±10	570±10	800±10
GY46X08	8/200	584(570)±2	900±10	650±10	900±10

## LIMITED WARRANTY

JYCO FIRE CORP. hereby referred to as JYCO FIRE warrants to the original purchaser of the fire protection products manufactured by JYCO FIRE and to any other person to whom such equipment is transferred, that such products will be free from defect in material and workmanship under normal use and care, for two (2) years from the date of shipment by JYCO FIRE. Products or Components supplied or used by JYCO FIRE, but manufactured by others, are warranted only to the extent of the manufacturer's warranty. No warranty is given for product or components which have been subject to misuse, improper installation, corrosion, unauthorized repair, alteration or un-maintained. JYCO FIRE shall not be responsible for system design errors or improper installation or inaccurate or incomplete information supplied by buyer or buyer's representatives. JYCO FIRE will repair or replace defective material free of charge, which is returned to our factory, transportation charge prepaid, provided after our inspection the material is found to have been defective at the time of initial shipment from our works. JYCO FIRE shall not be liable for any incidental or consequential loss, damage or expense arising directly or indirectly from the use of the product including damages for injury to person, damages to property and penalties resulting from any products and components manufactured by JYCO FIRE. JYCO FIRE shall not be liable for any damages or labour charges or expense in making repair or adjustment to the product. JYCO FIRE shall not be liable for any damages or charges sustained in the adaptation or use of its engineering data & services. In no event shall JYCO FIRE's product liability exceed an amount equal to the sale price. The foregoing warranty is exclusive and in lieu of all other warranties and representation whether expressed, implied, oral or written, including but not limited to, any implied warranties or merchantability or fitness for a particular purpose. All such other warranties and representations are hereby cancelled.

## NOTICE :

The equipment presented in this bulletin is to be installed in accordance with the latest publication standards of NFPA or other similar organisations and also with the provision of government codes or ordinances wherever applicable.

The information provided by us is to the best of our knowledge and belief, and consist of general guidelines only. Site handling and installation control is not in our scope. Hence we give no guarantee for result and take no liability for damages, loss or penalties whatsoever, resulting from our suggestion, information, recommendation or damages due to our product. Product development is a continuous programme of JYCO FIRE CORP. and hence the right to modify any specification without prior notice is reserved with the company.



**JYCO FIRE CORP.**  
Comprehensive protection

Ximei Town, Nan'an City, Fujian province, China.

• TEL: +86 15905012778

• WEB: <https://jycofire.com>

• EMAIL: [jycofire@gmail.com](mailto:jycofire@gmail.com)